



TOREX®



1

TECHNICAL CATALOGUE

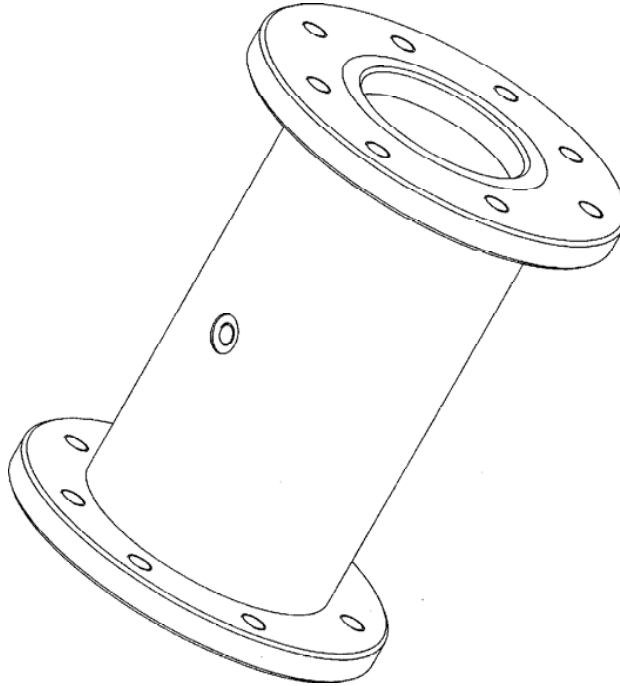

VM

- **PINCH VALVES**
TECHNICAL CATALOGUE
- **ピンチバルブ**
技術仕様書
- **VANNESMANCHON**
CATALOGUE TECHNIQUE
- **VALVOLE A MANICOTTO**
CATALOGO TECNICO

All rights reserved © WAMGROUP

CATALOGUE No.		TO.800 T.		CREATIONDATE
ISSUE A3	CIRCULATION 100	DATE OF LATEST UPDATE 01.04		

<p>TYPE Pinch valve</p> <p>DESCRIPTION Material flow intercepting valve.</p> <p>USE VM pinch valves are designed to control the delivery of powder or granulated products during pneumatic transport, particularly during the pneumatic loading of silos from tankers.</p> <p>IMPROPER USE VM pinch valves are NOT designed to work in dangerous conditions or with dangerous materials. If the equipment has to be operated in these conditions the Manufacturer must be informed.</p> <p>Dangerous materials: - explosives - toxic - inflammable - harmful and similar.</p> <p>Dangerous applications: - conveying or filling the materials listed above into bins or silos.</p>	<p>型式 ピンチバルブ</p> <p>名称 材料フローのインターセプティングバルブ</p> <p>使用法 VM型ピンチバルブは、空圧輸送、特にタンカからサイロへ空圧荷上する間の粉末状または粒子状製品の輸送を制御するために設計されています。</p> <p>不適切な使用法 VM型ピンチバルブは、危険な条件下で、または危険な材料を使って作業できるようには設計されていません。もし当該装置がこれらの条件下で運転される場合には、事前に製造者にその旨を通告しなければなりません。</p> <p>危険な材料とは下記を指しません。 - 爆発性 - 毒性 - 引火性 - 有害性または類似のもの</p> <p>危険な用途: - 上記の材料をピンまたはサイロへ搬送または充填する作業</p>	<p>TYPE Vanne à manchon</p> <p>DESCRIPTION Vanne d'interception</p> <p>UTILISATION Les vannes à manchon modèle VM sont indiquées pour intercepter des produits en poudre ou granulaires pendant le transport pneumatique, en particulier pendant le remplissage pneumatique des silos au moyen d'un camion citerne.</p> <p>CONTRE-INDICATIONS Les vannes à manchon standard de la classe VM N'ONT PAS été projetées pour travailler dans ces conditions ou avec des matières dangereuses. Par conséquent, quand l'équipement doit remplir cette condition le constructeur doit obligatoirement en être informé.</p> <p>Sont considérées matériaux dangereuses: - toxiques - inflammables - nocifs et semblables</p> <p>Sont considérées applications dangereuses: - extraction de silos ou chambres contenant des matières dangereuses.</p>	<p>TIPO Valvola a manicotto</p> <p>DESCRIZIONE Valvola intercettazione materiali.</p> <p>FUNZIONE D'USO Le valvole a manicotto modello VM sono indicate per l'intercettazione di prodotti in polvere o granulari durante il trasporto pneumatico, in particolare durante il carico pneumatico di silo mediante autocisterna.</p> <p>CONTROINDICAZIONI Le valvole a manicotto standard della classe VM NON sono state progettate per operare in condizioni o con materiali pericolosi; pertanto quando la macchina deve assolvere a queste esigenze è d'obbligo informare il costruttore.</p> <p>Si ritengono materiali pericolosi: - materiali esplosivi - tossici - infiammabili, - nocivi e/o simili.</p> <p>Si ritengono applicazioni pericolose: - estrazione da silo o celle contenenti i suddetti materiali.</p>
--	--	---	---



- ORDER CODES
 - 注文コード
 VM - CODES DE SELECTION
 - CODICI DI SCELTA

01.03 / 02.01

1

TO.800 T.5

Valve Ventil Vanne Valvola	∅	Inlet 入口 Entrée Ingresso	Outlet 出口 Sortie Uscita	Sleeve スリーブ Manchon Manicotto
-------------------------------------	---	-----------------------------------	----------------------------------	--

0	Natural rubber-天然ゴム
1	NBR food-grade-NBR 食品等級
2	EPDM

A	Flange and bush in aluminium-アルミ製フランジとブッシュ
B	Aluminium flange and hardened bush-アルミ製フランジと硬化ブッシュ
C	Aluminium flange and Stainless steel (AISI 304) bush-アルミ製フランジとステンレス鋼AISI - 304製ブッシュ
D	Aluminium flange and Stainless steel (AISI 316) bush-アルミ製フランジとステンレス鋼AISI - 316製ブッシュ
E	Flange and bush in aluminium (USA norm)-(米国基準)アルミ製フランジとブッシュ
F	Aluminium threaded bush-アルミ製ねじ付きブッシュ
G	Plastic threaded bush-プラスチック製ねじ付きブッシュ
H	Stainless steel (AISI 304) threaded bush-ステンレス鋼AISI - 304製ねじ付きブッシュ
I	Stainless steel (AISI 316) threaded bush-ステンレス鋼AISI - 316製ねじ付きブッシュ
L	Hardened threaded bush-硬化ねじ付きブッシュ
M	Stainless steel (AISI 304) threaded bush Thyssen - (Thyssen) ステンレス鋼AISI-304製ブッシュ

A	Flange and bush in aluminium-アルミ製フランジとブッシュ
B	Aluminium flange and hardened bush-アルミ製フランジと硬化ブッシュ
C	Aluminium flange and Stainless steel (AISI - 304) bush-アルミ製フランジとステンレス鋼 (AISI-304)製ブッシュ
D	Aluminium flange and Stainless steel (AISI - 316) bush-アルミ製フランジとステンレス鋼 (AISI-316)製ブッシュ
E	Flange and bush in aluminium (USA norm)-(米国基準)アルミ製フランジとブッシュ
F	Aluminium threaded bush-アルミ製ねじ付きブッシュ
G	Plastic threaded bush - プラスチック製ねじ付きブッシュ
H	Stainless steel (AISI 304) threaded bush-ステンレス鋼 (AISI - 304)製ねじ付きブッシュ
I	Stainless steel (AISI 316) threaded bush-ステンレス鋼 (AISI - 316)製ねじ付きブッシュ
L	Hardened threaded bush-硬化ねじ付きブッシュ
M	Stainless steel (AISI 304) threaded bush (Thyssen)-(Thyssen) ステンレス鋼 (AISI-304)製ねじ付きブッシュ

013	13	065	65
020	20	080	80
025	25	100	100
032	32	125	125
040	40	150	150
050	50	200	200

mm

VM

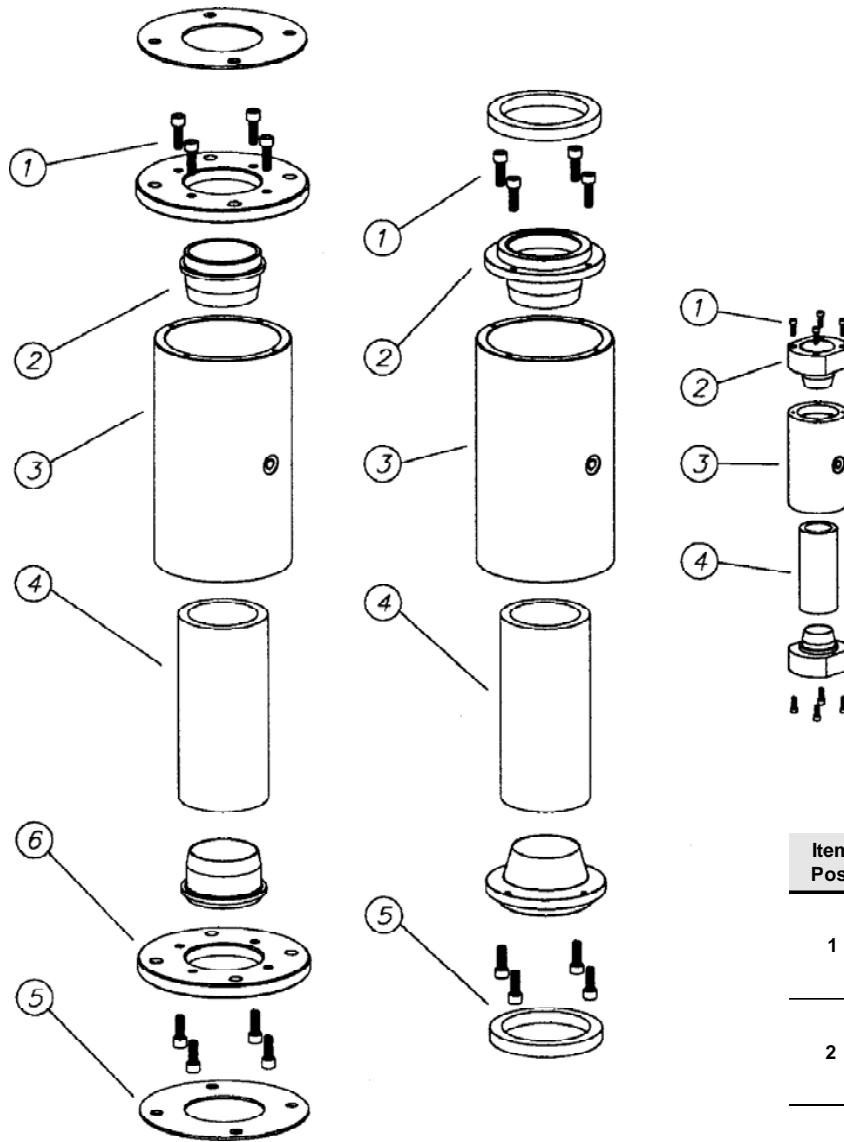

Item Pos.	Description - 名称 Désignation - Descrizione
1	Bolts ボルト Vis Viti
2	Bush ブッシュ Embout Boccola
3	Body 本体 Corps Corpo
4	Sleeve スリーブ Manchon Manicotto
5	Seal シール Joint Guarnizione
6	Flange フランジ Bride Flangia

PINCH VALVE CONTROL

Two versions available

VMX - TYPE**ピンチバルブ制御**

二つのバージョンがあります。

型式 VMX**COMMANDE POUR VANNE A MANCHON**

Disponible en deux versions

TYPE VMX**COMANDO PER VALVOLA A MANICOTTO**

Disponibile in due versioni

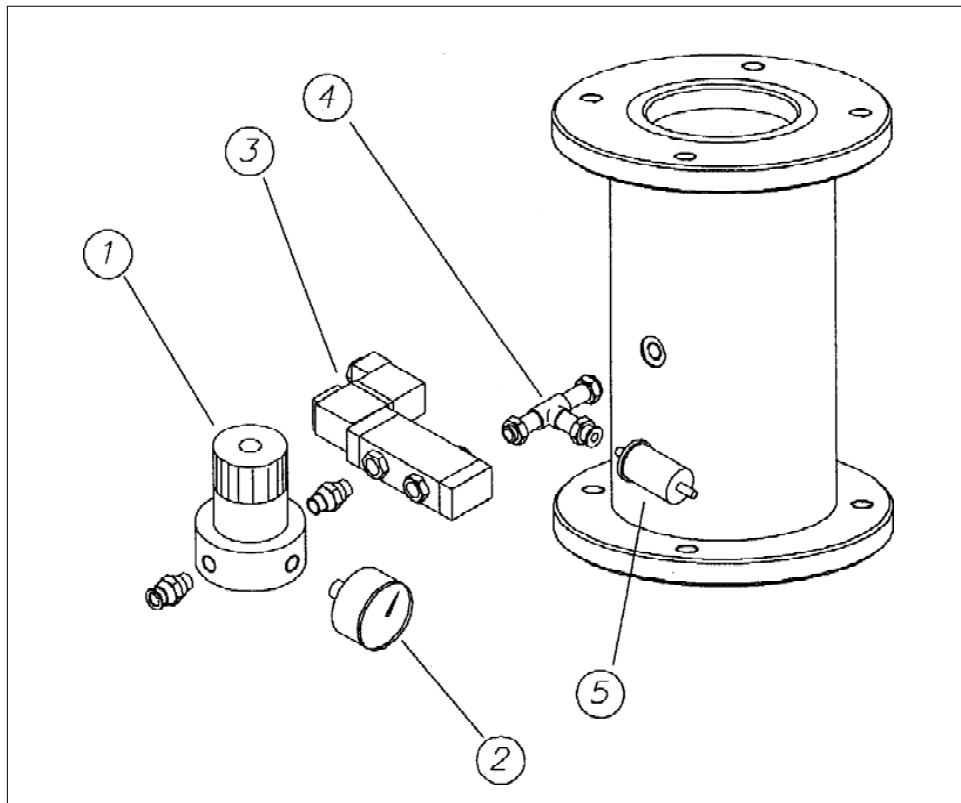
TIPO "VMX"

Item 項目	Description - 名称 Désignation - Descrizione
1	Pressure reducer 1/4" 減圧機 1/4" Réducteur de pression 1/4" Riduttore di pressione 1/4"
2	Gauge Ø 40 flange AB ゲージ Ø 40 フランジ AB Manomètre Ø 40 bride AB Manometro Ø 40 flang. AB
3	Solenoid valve 1.6" 3 ways NO 6 W ソレノイドバルブ 1/8" 3方向 No. 6 W Electrovanne 1.6" 3 voies NO 6 W Elettrovalvola 1/8" 3 vie NA 6 W
4	T-nipple 1/8" T-ニッパル 1/8" Raccord à T 1/8" Raccordo a T 1/8"
5	Pressure switch 1/4" M PN 圧カスイッチ 1/4" M PN Pressostat 1/4" M PN Pressostato 1/4" M PN

PINCH VALVE CONTROL
 VMX01-TYPE

ピンチバルブ制御
 型式 - V M X 0 1

COMMANDE POUR VANNE A
 MANCHON TYPE VMX01

COMANDO VALVOLA A
 MANICOTTO TIPO VMX01

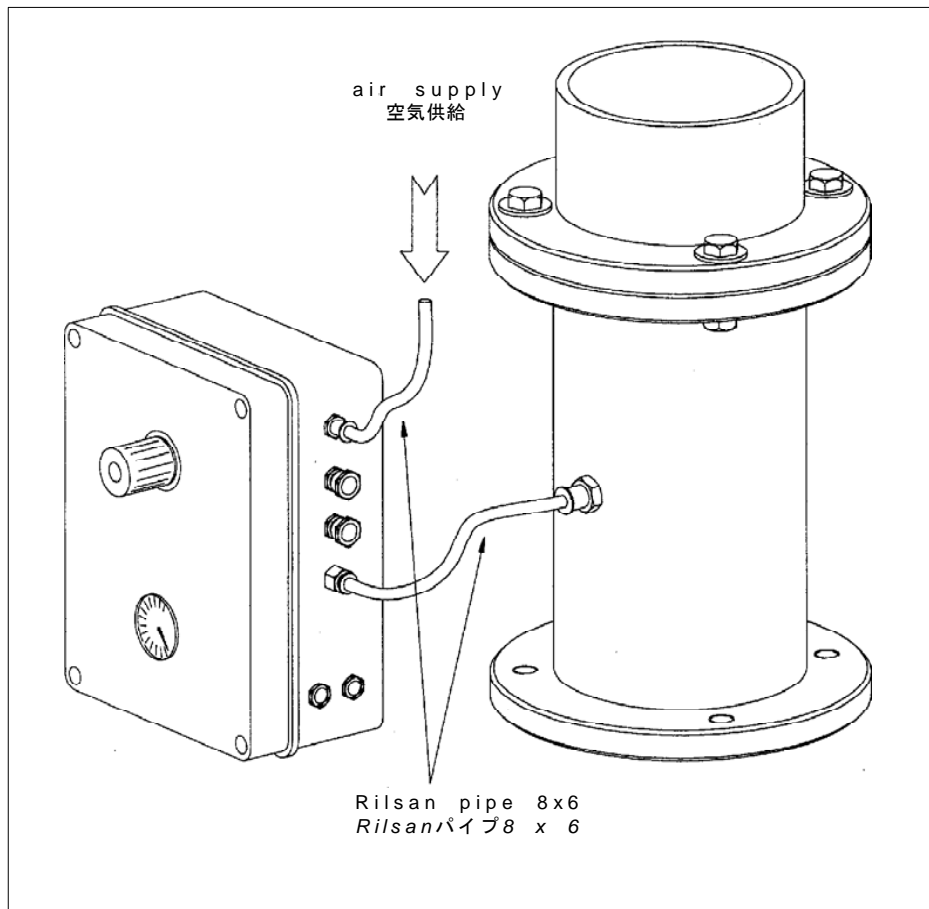
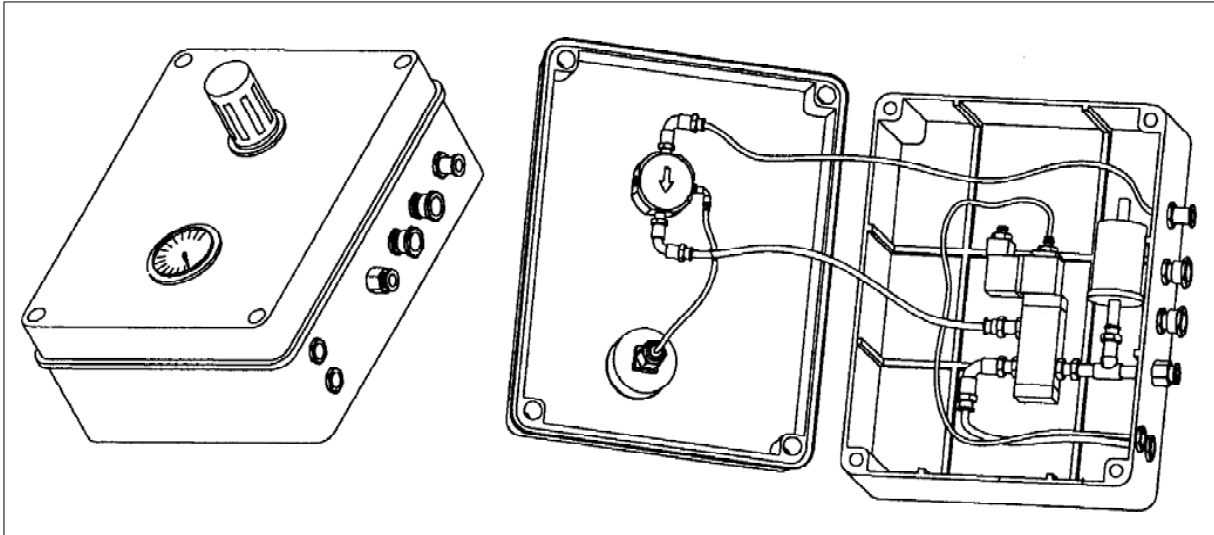

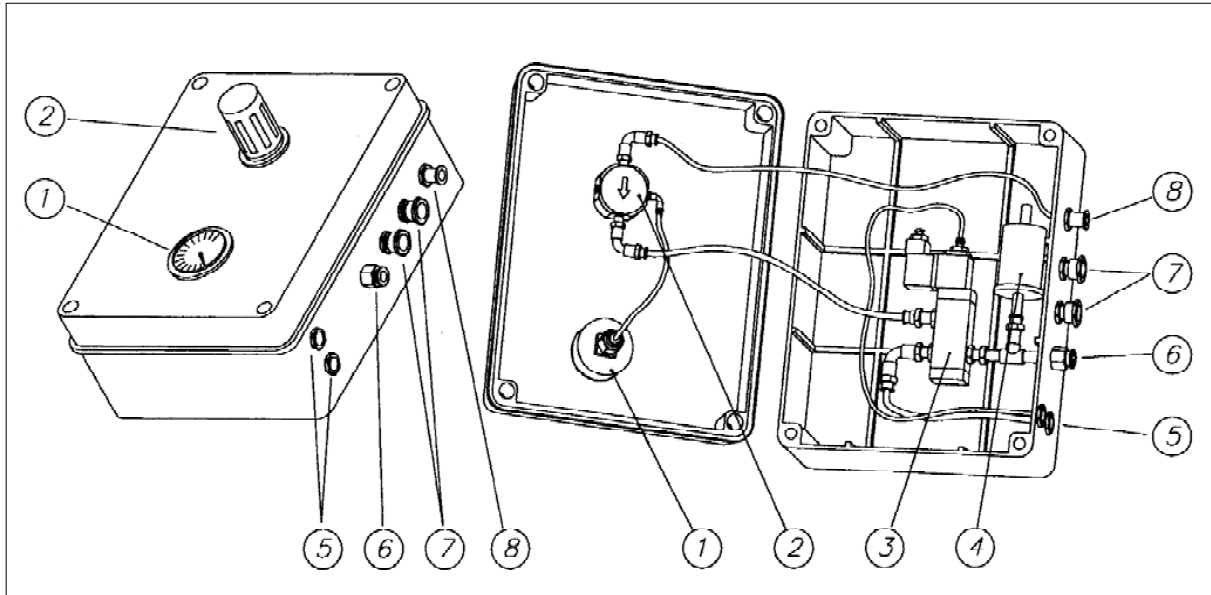

Item 項目	Description - 名称 Désignation - Descrizione
1	Pressure gauge 圧力計 Manomètre Manometro
2	Pressure reducer 減圧機 Réducteur de pression Riduttore di pressione
3	Solenoid valve ソレノイドバルブ Electrovanne Elettrovalvola
4	Pressure switch 圧カスイッチ Pressostat Pressostato
5	Air outlets 空気出口 Sorties d'air Scarichi aria
6	Quick coupling 8x6 - delivery 急速継手 8 x 6 - 送付 Prise rapide 8 x 6 - refolement Attacco rapido 8 x 6 - mandata
7	ケーブルグランド PG 9 Kabelverschraubungen PG 9 Presse-étoupes câbles PG 9 Pressacavi PG 9
8	急速継手 8x6 - 給送 Schnellanschluß 8 x 6 - Einlaß Prise rapide 8 x 6 - alimentation Attacco rapido 8 x 6 - alimentazione

**SOLENOID VALVE
 TECHNICAL DATA
 (Page T.7, Item 3)**

- Operating temperature:
-10° C + 50° C
- Connecting electric cable:
3 x 1.5mm²
- Input: 24V / 50-60 Hz
- Compressed air pipe:
6x8mm
- Protection: IP 55
- Operating pressure: 3.5 bar
- Energy consumption: 10 W

**ソレノイドバルブ
 技術データ
 (T.7 ページの項目3を参照)**

- 運転温度: -10° C ~ +50° C
- 電氣的ワイヤの結線:
3 x 1.5 mm²
- 入力: 24V, 50-60Hz
- 圧縮エアパイプ:
6 x 8mm
- 保護等級: IP 55
- 運転圧力: 3.5 bar
- 電力消費量: 10W

**ELECTROVANNE
 DONNEES TECHNIQUES
 (Page T.7, Pos. 3)**

- Température d'exercice:
-10° C + 50° C
- Câble de connexion électrique:
3 x 1.5 mm²
- Alimentation: 24 V, 50-60 Hz
- Tuyau pour air comprimé:
6 x 8 mm
- Protection: IP 55
- Pression d'exercice: 3.5 bar
- Consommation d'énergie: 10 W

**ELETTRORVALVOLA
 DATI TECNICI
 (Pagina T.7, Pos. 3)**

- Temperatura d'esercizio:
-10° C + 50° C
- Cavo di collegamento elettrico:
3 x 1.5 mm²
- Alimentazione: 24V, 50/60 Hz.
- Tubo per aria compressa:
6x8 mm
- Protezione: IP 55
- Pressione d'esercizio: 3.5 bar
- Consumo energia: 10 W

WIRING DIAGRAM SOLENOID VALVE 1/8"3 WAYS NO 6W

ソレノイドバルブの配線図1/8"3方向NO6W

SCHEMA DE CONNEXION ELECTROVANNE 1/8"3 VOIES NO 6W

SCHEMA DI COLLEGAMENTO ELETTRORVALVOLA 1/8"3 VIE NA 6W

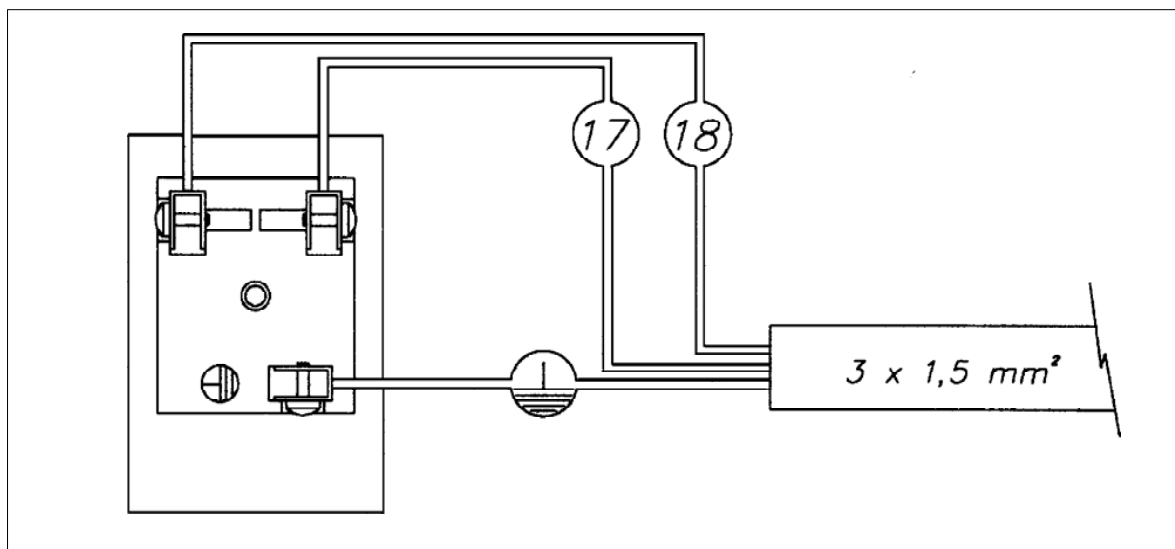

WIRING DIAGRAM PRESSURE SWITCH

圧カスイッチの配線図

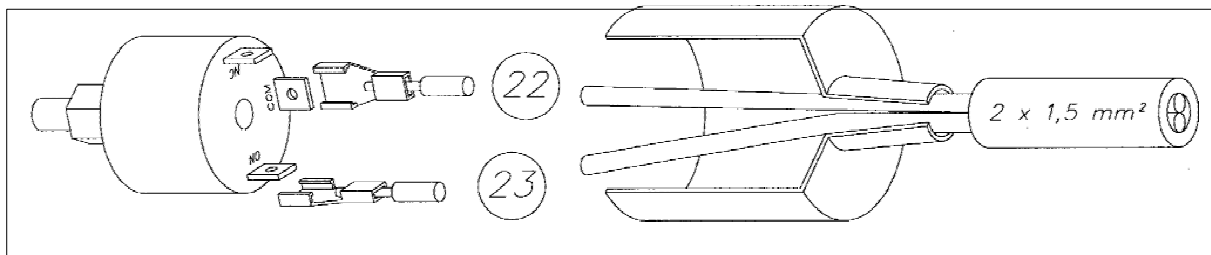

VMX - INSIDE VIEW - VMX - 内面図
VMX - ASPECT INTERIEUR - VMX - ASPETTO INTERNO

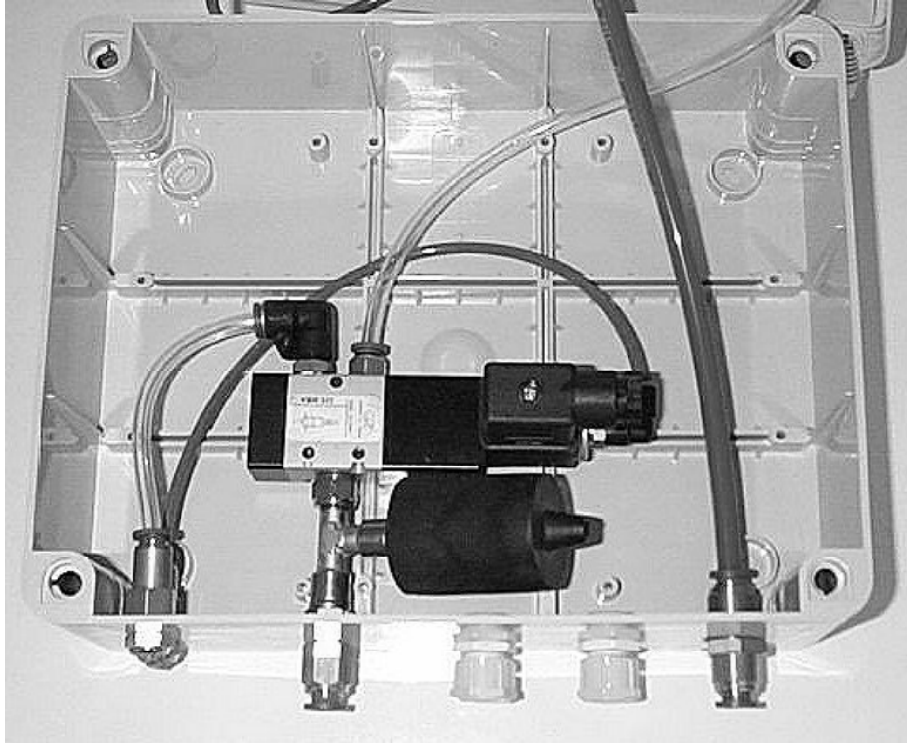

VMX - OUTSIDE VIEW - VMX - 外径図
VMX - ASPECT EXTERIEUR - VMX - ASPETTO ESTERNO

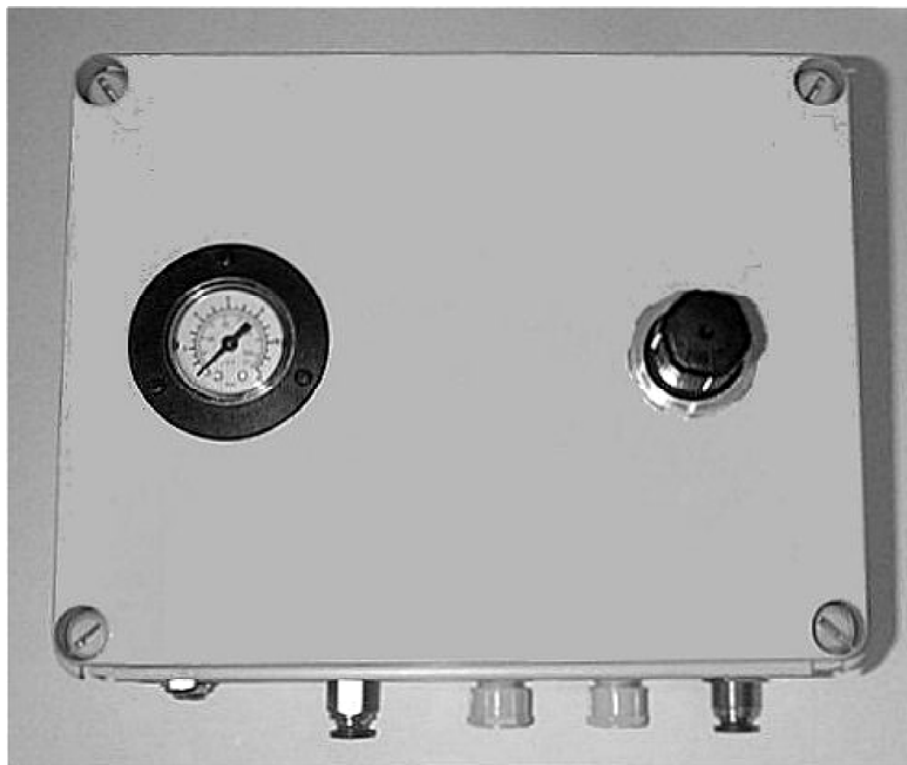

VM - Operating pressure: 3.5 bar - Pressure differential on sleeve: 1.5 - 2 bar - Operating temperature on sleeve: -20 °C to +80 °C on natural rubber sleeve	VM型 - 運転圧力: 3.5 bar - スリーブの差圧: 1.5 - 2.0 bar - スリーブの運転温度: -20 °C から +80 °C	VM - Pression d'exercice: 3.5 bar - Pression différentielle sur manchon: 1.5 - 2.0 bar - Température d'exercice sur manchon: -20 °C à +80 °C avec manchon en caoutchouc naturel	VM - Pressione operativa: 3.5 bar - Pressione differenziale sul manicotto: 1.5 - 2.0 bar - Temperatura di esercizio sul manicotto: -20 °C +80 °C con manicotto in gomma naturale
SOLENOID VALVES VMX – VMX01 - Operating temperature: -10 °C to +50 °C - Operating voltage: 24 V, 50-60 Hz - Connecting electric cable: 3 x 1.5mm ² - Connecting air pipe: 6 x 8mm - Energy consumption: 10 W - Protection: IP 55 - Operating pressure: 3.5 bar	ソレノイドバルブ VMX/VMX01型 - 運転温度: -10 °C から +50 °C - 運転電圧: 24 V, 50 - 60 Hz - 電氣的ケーブルの結線: 3 x 1.5 mm ² - 空気パイプの接続: 6 x 8 mm - 電力消費量: 10 W - 保護等級: IP 55 - 運転圧力: 3.5 bar	ELECTROVANNES VMX – VMX01 - Température d'exercice: -10 °C à +50 °C - Tension d'alimentation: 24 V, 50-60 Hz - Câble de connexion électrique: 3 x 1.5 mm ² - Tuyau de connexion d'air comprimé: 6 x 8 mm - Consommation d'énergie: 10 W - Protection: IP 55 - Pression d'exercice: 3.5 bar	ELETTRIVALVOLE VMX – VMX01 - Temperatura di esercizio: -10 °C ... +50 °C - Tensione di alimentazione: 24 V, 50-60 Hz - Cavo di collegamento elettrico: 3 x 1.5 mm ² - Tubo di collegamento aria compressa: 6 x 8 mm - Consumo energia: 10 W - Protezione: IP 55 - Pressione di esercizio: 3.5 bar
VMXA – VMX01A - Operating temperature: -10 °C to +50 °C - Operating voltage: 24 V DC - Connecting electric cable: 3 x 1.5mm ² - Connecting air pipe: 6 x 8mm - Energy consumption: 10 W - Protection: IP 55 - Operating pressure: 3.5 bar	VMXA/VMX01A型 - 運転温度: -10 °C ~ +50 °C - 運転電圧: 24 Volt DC - 電氣的ケーブルの結線: 3 x 1.5 mm ² - 空気パイプの接続: 6 x 8 mm - 電力消費量: 10 W - 保護等級: IP 55 - 運転圧力: 3.5 bar	VMXA – VMX01A - Température d'exercice: -10 °C à +50 °C - Tension d'alimentation: 24 V CC - Câble de connexion électrique: 3 x 1.5 mm ² - Tuyau de connexion d'air comprimé: 6 x 8 mm - Consommation d'énergie: 10 W - Protection: IP 55 - Pression d'exercice: 3.5 bar	VMXA – VMX01A - Temperatura di esercizio: -10 °C ... +50 °C - Tensione di alimentazione: 24 V C.C. - Cavo di collegamento elettrico: 3 x 1.5 mm ² - Tubo di collegamento aria compressa: 6 x 8 mm - Consumo energia: 10 W - Protezione: IP 55 - Pressione di esercizio: 3.5 bar
VMXB – VMX01B - Operating temperature: -10 °C to +50 °C - Operating voltage: 110 V, 50-60 Hz - Connecting electric cable: 3 x 1.5mm ² - Connecting air pipe: 6 x 8mm - Energy consumption: 10 W - Protection: IP 55 - Operating pressure: 3.5 bar	VMXB/VMX01B型 - 運転温度: 10 °C ~ +50 °C - 運転電圧: 110 V, 50 - 60 Hz - 電氣的ケーブルの結線: 3 x 1.5 mm ² - 空気パイプの接続: 6 x 8 mm - 電力消費量: 10 W - 保護等級: IP 55 - 運転圧力: 3.5 bar	VMXB – VMX01B - Température d'exercice: -10 °C à +50 °C - Tension d'alimentation: 110 V, 50-60 Hz - Câble de connexion électrique: 3 x 1.5 mm ² - Tuyau de connexion d'air comprimé: 6 x 8 mm - Consommation d'énergie: 10 W - Protection: IP 55 - Pression d'exercice: 3.5 bar	VMXB – VMX01B - Temperatura di esercizio: -10 °C ... +50 °C - Tensione di alimentazione 110 Volt 50-60 Hz - Cavo di collegamento elettrico: 3 x 1.5 mm ² - Tubo di collegamento aria compressa: 6 x 8 mm - Consumo energia: 10 W - Protezione: IP 55 - Pressione di esercizio: 3.5 bar

<p>VMXC – VMX01D</p> <ul style="list-style-type: none"> - Operating temperature: -10 °C to +50 °C - Operating voltage: 220 V, 50-60 Hz - Connecting electric cable: 3 x 1.5mm² - Connecting air pipe: 6 x 8mm - Energy consumption: 10 W - Protection: IP 55 - Operating pressure: 3.5 bar 	<p>VMXc / VMX01D型</p> <ul style="list-style-type: none"> - 運転温度: -10 °C ~ +50 °C - 運転電圧: 220 V, 50-60 Hz - 電氣的ケーブルの結線: 3 x 1.5 mm² - 空気パイプの接続: 6x8 mm - 電力消費量: 10 W - 保護等級: IP 55 - 運転圧力: 3.5 bar 	<p>VMXC – VMX01D</p> <ul style="list-style-type: none"> - Température d'exercice: -10 °C à +50 °C - Tension d'alimentation: 220 V, 50-60 Hz - Câble de connexion électrique: 3 x 1.5 mm² - Tuyau de connexion d'air comprimé: 6 x 8 mm - Consommation d'énergie: 10 W - Protection: IP 55 - Pression d'exercice: 3.5 bar 	<p>VMXC – VMX01D</p> <ul style="list-style-type: none"> - Temperatura di esercizio: -10 °C ... +50 °C - Tensione di alimentazione: 220 Volt 50/60 Hz - Cavo di collegamento elettrico: 3 x 1.5 mm² - Tubo di collegamento aria compressa: 6 x 8 mm - Consumo energia: 10 W - Protezione: IP 55 - Pressione di esercizio: 3.5 bar
<p>VMX01C</p> <ul style="list-style-type: none"> - Operating temperature: -10 °C to +50 °C - Operating voltage: 24 V DC with double solenoid - Connecting electric cable: 3 x 1.5mm² - Connecting air pipe: 6 x 8mm - Energy consumption: 10 W - Protection: IP 55 - Operating pressure: 3.5 bar 	<p>VMX01C</p> <ul style="list-style-type: none"> - 運転温度: -10 °C ~ +50 °C - 運転電圧: ダブルソレノイド付き 24V DC - 電氣的ケーブルの結線: 3 x 1.5 mm² - 空気パイプのP接続: 6x8mm - 電力消費量: 10 W - 保護等級: IP 55 - 運転圧力: 3.5 bar 	<p>VMX01C</p> <ul style="list-style-type: none"> - Température d'exercice: -10 °C à +50 °C - Tension d'alimentation: 24 V CC à double solénoïde - Câble de connexion électrique: 3 x 1.5 mm² - Tuyau de connexion d'air comprimé: 6 x 8 mm - Consommation d'énergie: 10 W - Protection: IP 55 - Pression d'exercice: 3.5 bar 	<p>VMX01C</p> <ul style="list-style-type: none"> - Temperatura di esercizio: -10 °C ... +50 °C - Tensione di alimentazione: 24 Volt C.C. a doppio solenoide - Cavo di collegamento elettrico: 3 x 1.5 mm² - Tubo di collegamento aria compressa: 6 x 8 mm - Consumo energia: 10 W - Protezione: IP 55 - Pressione di esercizio: 3.5 bar
<p>PRESSURE SWITCH</p> <ul style="list-style-type: none"> - Operating temperature: -20 °C to +80 °C - Operating pressure: 8 - 10 bar - Electric contacts: 220 V / 3 A - Connecting electric cable: 2 x 1.5 mm² - Energy consumption: 0.5 W - Protection: IP 55 - Calibration pressure: 1.5 bar 	<p>圧力計</p> <ul style="list-style-type: none"> - 運転温度: -20 °C ~ +80 °C - 運転圧力: 8 - 10 bar - 電気コンタクト: 220 V, 3 A - 電氣的ケーブルの結線: 2 x 1.5 mm² - 電力消費量: 0.5 W - 保護等級: IP 55 - 校正 (キャリブレーション) 圧力: 1.5 bar 	<p>PRESSOSTAT</p> <ul style="list-style-type: none"> - Température d'exercice: -20 °C à +80 °C - Pression d'exercice: 8 - 10 bar - Contacts électriques: 220 V, 3A - Câble de connexion électrique: 2 x 1.5 mm² - Consommation d'énergie: 0.5 W - Protection: IP 55 - Pression d'étalonnage: 1.5 bar 	<p>PRESSOSTATO</p> <ul style="list-style-type: none"> - Temperatura di esercizio: -20 °C ... +80 °C - Pressione di esercizio: 8 - 10 bar - Contatti elettrici: 220 Volt / 3A - Cavo di collegamento elettrico: 2 x 1.5 mm² - Consumo energia: 0.5 W - Protezione: IP 55 - Pressione taratura: 1.5 bar

SHIPPING DATA - WEIGHTS / 船積データ- 重量 / COLISAGE - POIDS / INGOMBRI -

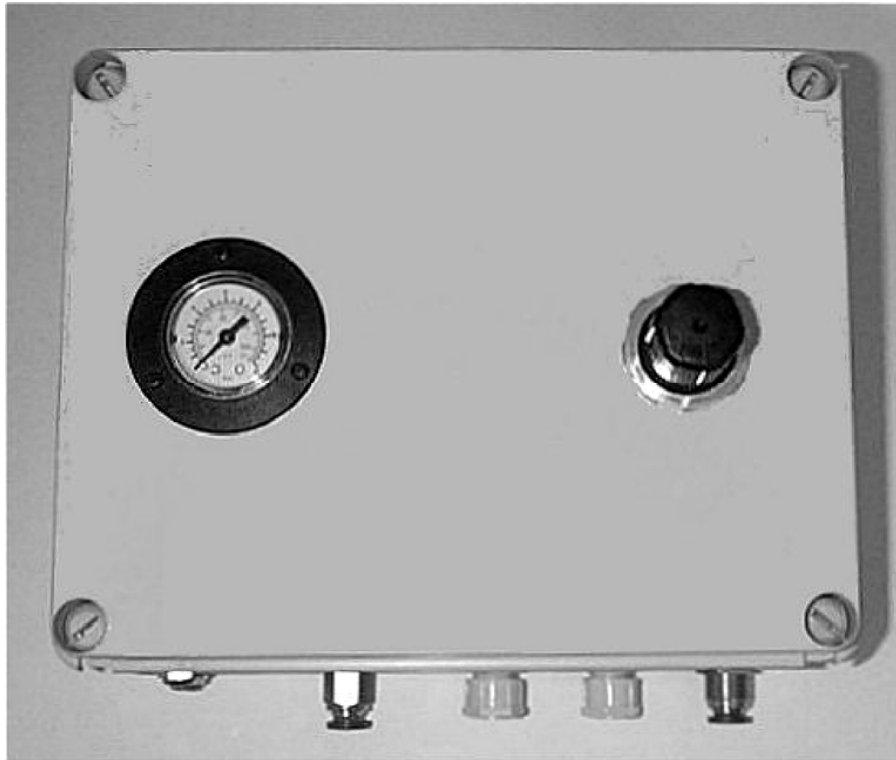

Box - ボックス 寸法	250x200x100
Protection 保護等級	IP 55
Weight - 重量	1.9 kg